

NEWPORT BLVD.

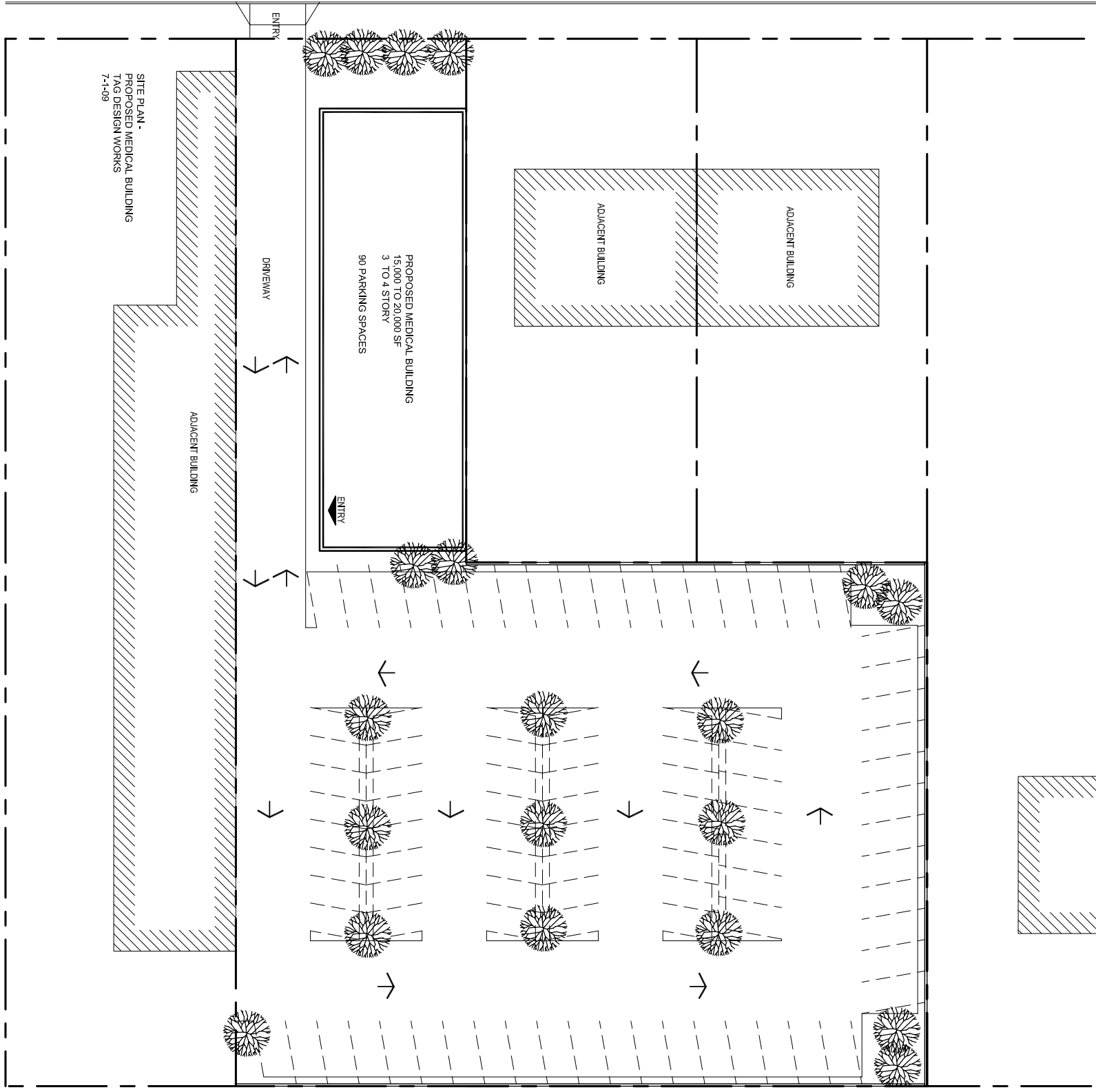

SITE PLAN -
PROPOSED MEDICAL BUILDING
TAG DESIGN WORKS
7-1-09

ADJACENT BUILDING

DRIVEWAY

PROPOSED MEDICAL BUILDING
15,000 TO 20,000 SF
3 TO 4 STORY
90 PARKING SPACES

ADJACENT BUILDING

ADJACENT BUILDING

ENTRY

ENTRY